



INSTALLATION AND OPERATION MANUAL

FVT1031(M)(S)-P

10-BIT DIGITAL VIDEO WITH BI-DIRECTIONAL DATA TRANSMITTER FOR PELCO DOME CAMERAS

The FVT1031(M)(S)-P series video transmitter along with the ComNet™ FVR1031 series receiver supports simultaneous broadcast-quality video transmission of 10-bit digital video and bi-directional RS422 data over one multimode or single mode optical fiber. The FVT1031(M)(S)-P is designed to plug directly into the Pelco Spectra III/IV dome, and connects with power, video input and two way data via the Pelco electrical connector.

See **Figures 1 – 4** for complete installation details.

FIGURE 1 – FVT1031-P TRANSMITTER

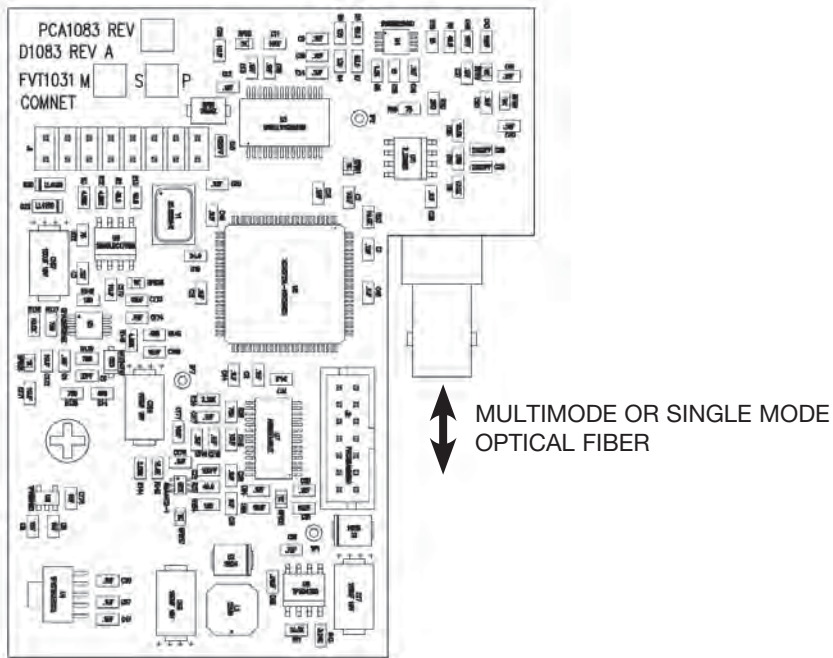

FIGURE 2 – TOP VIEW



FIGURE 3 – BOTTOM VIEW

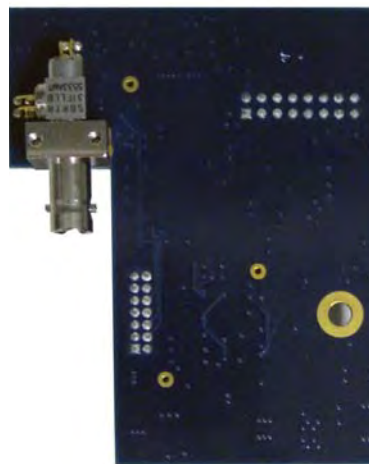
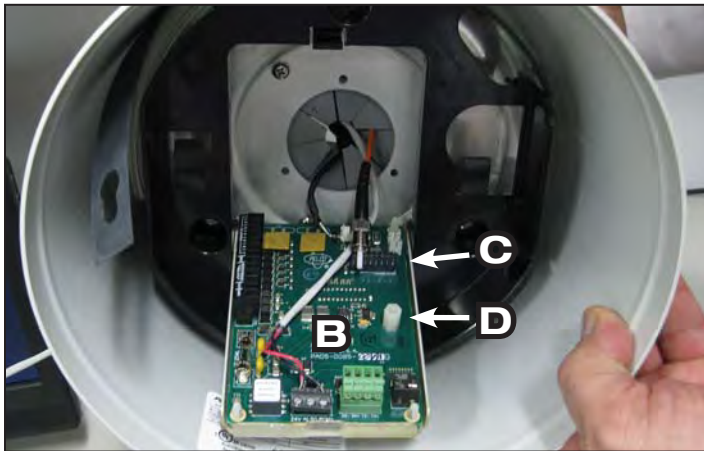

FIGURE 4 – MOUNTING INSTRUCTIONS

See your Pelco Spectra Dome III/IV installation manual for details of dome installation.



Remove lower dome and dome drive from Spectra III/IV dome according to the dome's instruction manual to reveal the back box (A).



Open the hinged door of Spectra III/IV back box to reveal the circuit board (B).

Carefully move the power wiring, if necessary, to allow room for mounting the FVT1031-P transmitter to the circuit board.

Remove the plug from the 16-pin connector on the circuit board (C).



Align the 16-pin connector on the dome circuit board with its counterpart on the top of the FVT1031-P and plug the header into the connector.

Using the supplied Phillips pan head screw with lock washer, secure the transmitter into the mounting standoff on the dome circuit board (D).

Connect the fiber optic connector on the transmitter to the dome's fiber optic adapter (E).

Close the back box and replace dome drive and lower dome according to the dome's instruction manual.

WARNING: Unit is to be used with a Listed Class 2 or LPS power supply rated 9-12 VDC @ 1A.

WARNING: This unit should be installed in a restricted access location; available through the use of a lock and key or other means of security. Access should be limited to service personnel who have been instructed about the reasons for the restrictions to the location. Any and all precautions should be taken and controlled by the authority responsible for the location.

IMPORTANT SAFEGUARDS:

A) Elevated Operating Ambient - If installed in a closed or multi-unit rack assembly, the operating ambient temperature of the rack environment may be greater than room ambient. Therefore, consideration should be given to installing the equipment in an environment compatible with the maximum ambient temperature (T_{ma}) specified by the manufacturer.

B) Reduced Air Flow - Installation of the equipment in a rack should be such that the amount of air flow required for safe operation of the equipment is not compromised.



3 CORPORATE DRIVE | DANBURY, CT 06810 | USA
T: 203.796.5300 | F: 203.796.5303 | TECH SUPPORT: 1.888.678.9427 | INFO@COMNET.NET

8 TURNBERRY PARK ROAD | GILDERSOME | MORLEY | LEEDS, UK LS27 7LE
T: +44 (0)113 307 6400 | F: +44 (0)113 253 7462 | INFO-EUROPE@COMNET.NET

INS_FVT1301-P_REV-
02/05/10
PAGE 4